

THE DEMPSEY

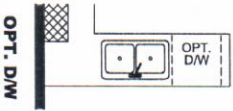
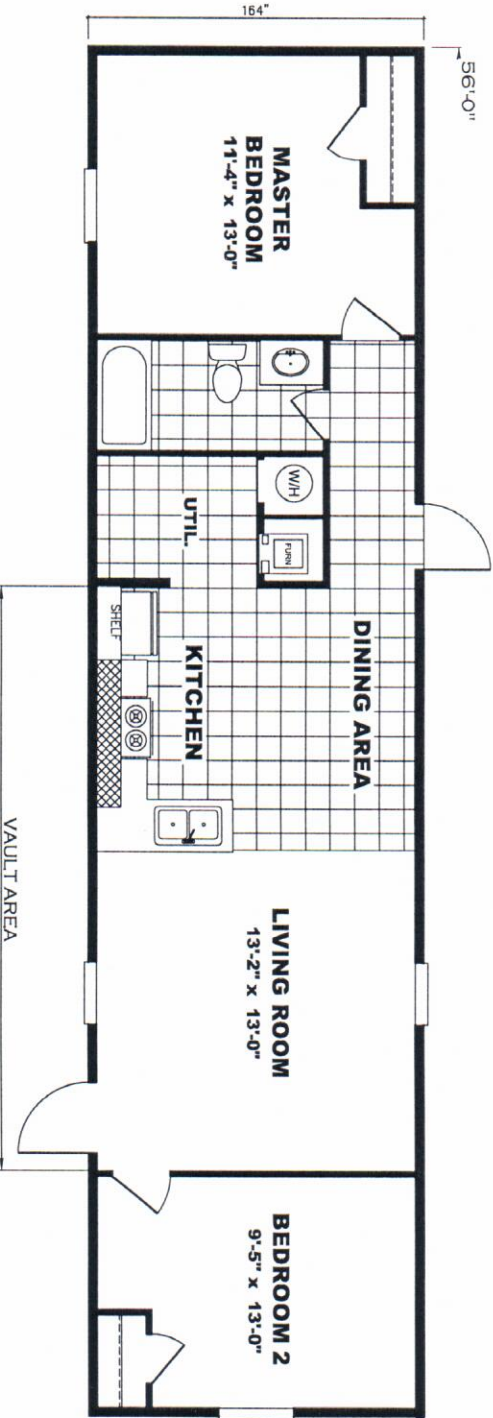

765 SQ.FT. (STD PLAN "CONDITIONED")
 SQ.FT. (W/OPT. PORCH/RECESS "CONDITIONED")

	Model #: TRU145G2A	Drawing #:
	Date: 11.19.12 Scale: N/A	975001

Product Designer: HUNTING | SALES LITERATURE



SINGLE SECTION Standard Specifications & Options

GENERAL

- HUD Code
- 20 lb. Roof Load Std., 30 psf optional
- Thermal Zone 1 Std., zones 2 and 3 optional
- Wind Zone 1 Std., zones 2 and 3 optional

FRAME

- I - Beam: 12" or 10" model specific
- Outriggers: 96" spacing
- Crossmembers: 96" spacing
- Header: (Front/Rear) Flush, not recessed
- Axles: Spread (no equalizers) overslung mounted.
- Brake Axles: One, except where more are mandatory by state DOT
- Hitch Beam: 8" Detachable Hitch

FLOOR

- Joists: 2x6 / 19.2" o.c.
- Carpet: Factory Select
- Carpet Bar: None
- Pad: 3.5 lb. (minimum) Rebond Pad
- Vinyl: Factory Select
- Decking: 19/32" 4x8 OSB T&G

EXTERIOR (7'-0" SIDEWALLS, 7'-0" ENDWALLS)

- Vinyl Siding: Standard
- Sheathing: WZ 1 - Foam standard, plant specific brand. WZ 2 & 3 - Includes OSB
- House Wrap: Over OSB (where used)
- Shutters: None

WINDOWS AND DOORS

- Front door: Out swing 34" x 76" blank, no storm.
- Rear door: Out swing 32" x 76" blank, no storm.
- Interior doors: Factory Select
- Windows: Metal single glaze, size per prints.
Metal storm windows for thermal zone 2 and 3 only.

ROOF / CEILING

- Design Load: 20 psf Live load standard, 30 psf options where needed
- Shingles: 20 year
- Trusses: 24" o.c. spacing
- Sheathing: 7/16" OSB
- Insulation: Blown Fiberglass
- Ceiling: Textured
- Ceiling Slope: Vault/Flat Ceiling
- Attic Ventilation: Pot vents (low), Ridge vent high

PLUMBING

- Water Heater: 30 gallon electric
- Kitchen Sink: Stainless Steel, dbl bowl
- Lavatory Sinks: Plastic
- Faucets: Plastic
- Master Bath: 54 ABS Plastic Tub
- Hall Bath: 54 ABS Plastic Tub
- Whole House Water Shut-off

HVAC

- Heat: Electric (gas optional).
- Ductwork: Metal duct
- Thermostat: 8 Wire

ELECTRICAL

- Load Center: 200 amp
(100 amp allowed when gas option ordered – gas range and gas furnace).
- Exterior Receptacles and Switches: (1) GFI recept and cover.
- Interior Receptacles and Switches: White, self contained
- Phone Jack(s): None
- AC: Conduit

WALLS

- Exterior Wall Construction: 2x4, 16" O.C. spacing
- Ext. Wall Height Sidewall = 7'-0", Endwall = 7'-0"
(combo vault/flat ceiling, per prints)
- Interior Wall Construction: 2x3, 24" O.C. spacing
- Wall Coverings: 3/8" minimum VOG or paper on gyp
- Wall Coverage at Closets: 3/8" gyp, raw

INTERIOR FEATURES

- Cabinets: MDF / 24" tall overheads.
- Countertops (All): Formica
- Backsplash: None
- Closet Shelving: Closet Maid – vinyl wrapped metal.
- Utility Shelving: None
- Refrigerator: 18 CF
- Range: Electric
- Range Hood: 30", 100 cfm min, vent through sidewall.
- Valance on LR windows only. No mini blinds

COLOR SCHEME - Factory Select

THERMAL (INSULATION AND WINDOW SPECS)

- Zone I (standard) Windows: Metal (mil finish), single pane (no storm),
Floor: R-11 Wall: R-11 Roof: R-11
- Zone II (optional) Windows: Metal (mil finish) single pane w/ storm,
Floor: R-11 Wall: R-11 Roof: R-14
- Zone III (optional) Windows: Metal (mil finish) single pane w/ storm,
Floor: R-22 Wall: R-11 Roof: R-28

OPTIONS AVAILABLE

1. Dishwasher
2. House Type Front Door w/ storm
3. Wire & Brace for Ceiling Fan
4. Thermal Zone II
5. Thermal Zone III
6. Wind Zone II, includes OSB
7. Wind Zone III, includes OSB and 16" O.C. Trusses
8. Thermal Pane dual glaze Vinyl Windows – available for Thermal Zone 3 only
9. Ice Dam Protection – TN Facility only
10. Gas Option: Range and Furnace. Use 100 amp main panel.
11. 30# roof load, 16" O.C. Trusses
12. OSB Wrap